

фазонски делови со прирабници и цевки

X завршеток со прирабница

X blank flanges

X blindflanshe

X završetak sa prirubnicom

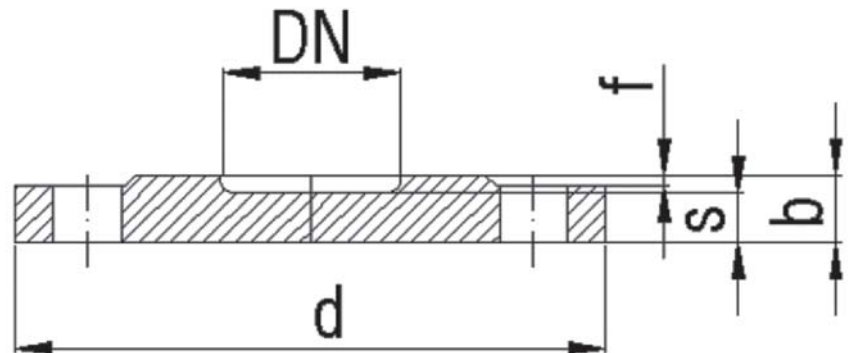
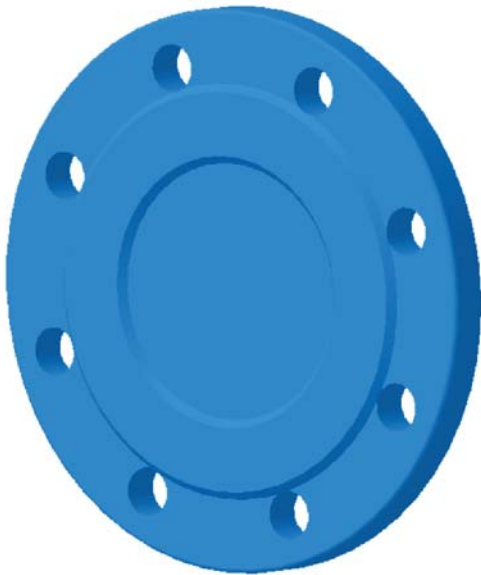

X EN 545 DIN 28646

GJS

DN	b		s		d		f	masa weight gewicht masa (kg)	
								PN10	PN16
50	19		16		165		3	2.9	2.9
65					185			3.8	3.8
80					200			4	4
100					220			4.6	4.6
125					250			6	6
150					285			7.6	7.6
200	20		17		340		11.4	11.2	
250	22		19		400		17.2	16.8	
300	24.5		20.5		455		25	24.5	
350	24.5	26.5	20.5	22.5	505	520	4	30	35
400		28		24	565	580		38	44
450	25.5	30	21.5	26	615	640		53	61
500	26.5	31.5	22.5	27.5	670	715		68	79
600	30	36	25	31	780	840	5	92	105