

фазонски делови со прирабници и цевки

FFR редуцир со прирабница

- FFR double socket tapers
- FFR reduktion mit flansches
- FFR reducir sa prirubnicom

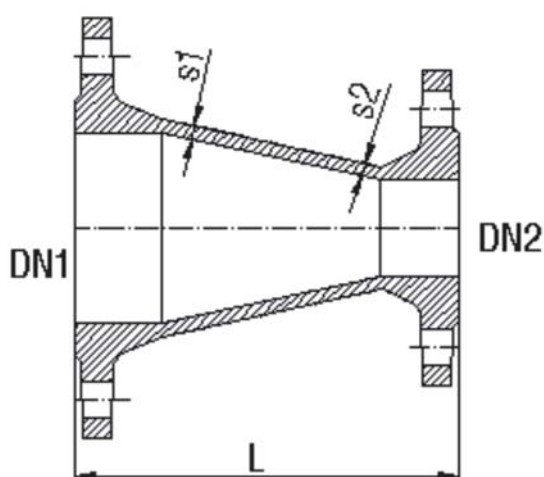
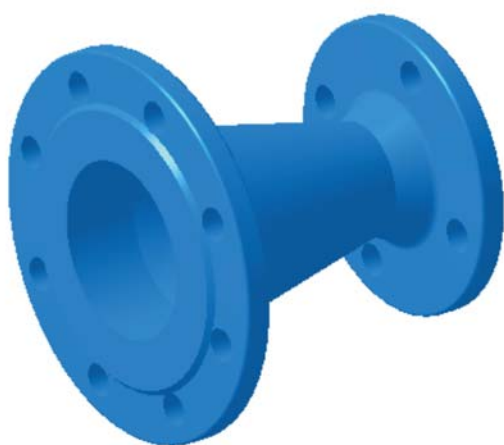

FFR EN 545 DIN 28645

GJS

DN1	DN2	L	S1	S2	maca weight gewicht masa (kg)		
					PN10	PN16	
					65	50	200
80	50	7.4	7.4				
100	65	200	7.2	7	8.2	8.2	
	80				8.1	8.1	
	100				8.8	8.8	
125	80	200	7.5	7.2	9.5	9.5	
	100				10.7	10.7	
150	80	200	7.8	7	11.4	11.4	
	100				11.9	11.9	
	125				12.2	12.2	
	150				12.8	12.8	
200	80	300	8.4	7	14.1	14.1	
	100				11.9	11.9	
	125				12.2	12.2	
	150				12.8	12.8	
250	100	300	9	7.2	18.1	17.7	
	125				18.6	18.2	
	150				20	19.6	
	200				22	21.6	
300	100	300	9.6	7.2	24	23.6	
	125				26	25.4	
	150				28	27.6	
	200				29	28.6	
*350	100	600	16.3	7.2	30.5	30.1	
	150				35.6	34.6	
	200				37	36	
	250				35.9	34.9	
*400	150	600	17.5	9	41	40	
	200				12.8	87	91.8
	250				14	96	101.3
	300				15.2	106	111.3
*450	200	600	17.5	9.6	12.8	98	104.8
	250				14	109	116.3
	300				15.2	120	127.3
	350				16.3	132	143.6
*500	300	600	19.8	16.3	130	143.1	
	350				145	162.4	
	400				158	177.4	
	450				146	164.8	
*600	350	600	22.2	17.5	160	183.1	
	400				174	195.1	
	450				186	316.9	
	500				210	249.4	
*600	450	600	22.2	19.8	222	267.2	
	500				239	290	

* моделите се за сив лив (SL) по DIN 28545
во изработка е нодуларна верзија

* patterns are for grey iron - DIN 28545
we are in phase of making nodular version