

канализациска арматура

GK жибо спојка - тип B, C, D
 GK gibault joints - tip B, C, D
 GK gibault - kupplung - tip B, C, D
 GK žibo spojka - tip B,C, D

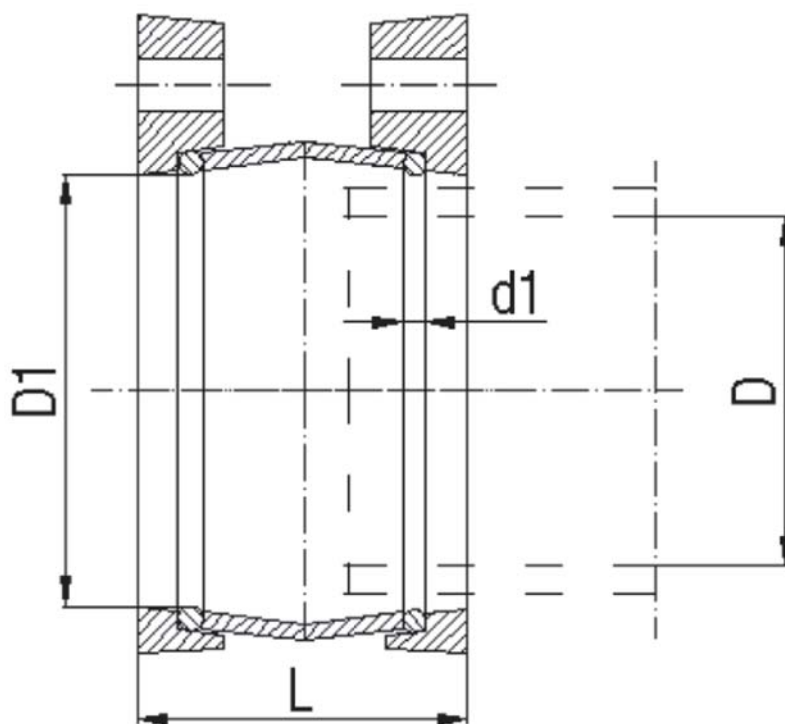

GK

GJL

D	L	O гумен прстен / O ring						завртка со навртка bolts schrauben		маса weight masse masa		
		D1			d1			n	M	B	C	D
		PN6	PN10	PN16	PN6	PN10	PN16			PN6	PN10	PN16
50	8.2	60			10			3	M 10X100	1.4		
60	8.6	70								1.6		
80	90	88								2.9		3
100	110	110			12			4	M 12X120	3.5	3.8	3.9
125		135								4.5	5	5.1
150		160								5.4	6	6.1
200	120	210			14			6	M 12X130	7.8	8	8.3
250	130	260								12.9	13.3	13.8
300		312	330	15.4						15.7	16	
350	145	365			14	17	6	M 16X140	21.1	21.2	24.7	
400		416			17				26.8	27.2	27.8	
450		468	520	34.4					35.1	39.1		
500	165	520	527	17	20	6	M 16X160	37.9	38.3	38.3		
600	180	620	665	20				8	M 16X200	58.8	59.5	62.8